

**EWD 215, EWD 260,
EWD 315, EWD 320,**

For more information, contact:
EnTech Supply
(800) 221-4785
www.entechsupply.com



**INSTRUCTIONS FOR USE
MODE D'EMPLOI
INSTRUCCIONES DE USO**

Euroclean

| | |
|-----------------|--------------------|
| ENGLISH | 3,4,5,6-9 |
| FRANÇAIS | 3,4,5,10-13 |
| ESPAÑOL | 3,4,5,14-17 |
| DATA | 18 |

**SAVE THESE INSTRUCTIONS
CONSERVER CES INSTRUCTIONS
GUARDE ESTAS INSTRUCCIONES**

HEPA-FILTER INSTALLATION INSTALLATION DE HEPA-FILTRE



1

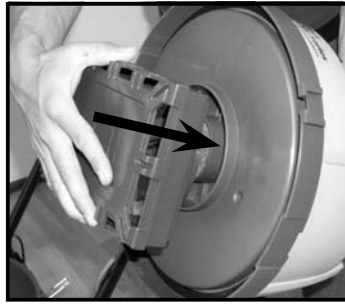

2



3



4

Basic operations

Attach hose



Remove hose

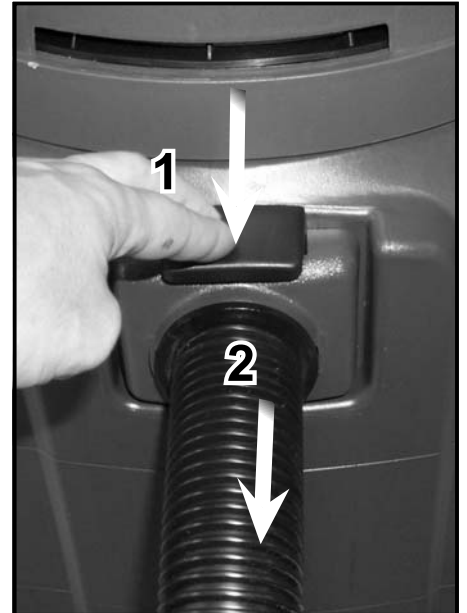

Dry use

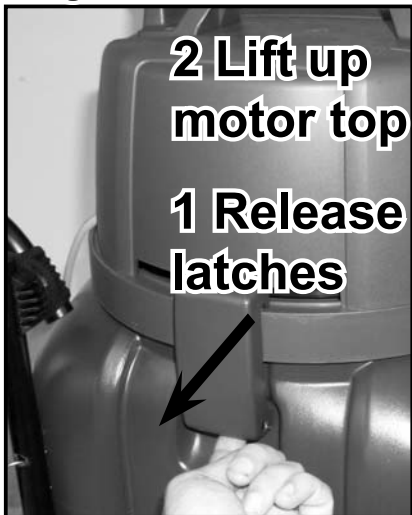

Fit the float

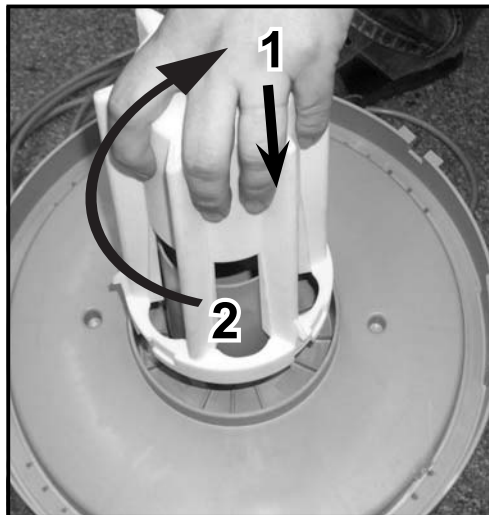

Dust bag

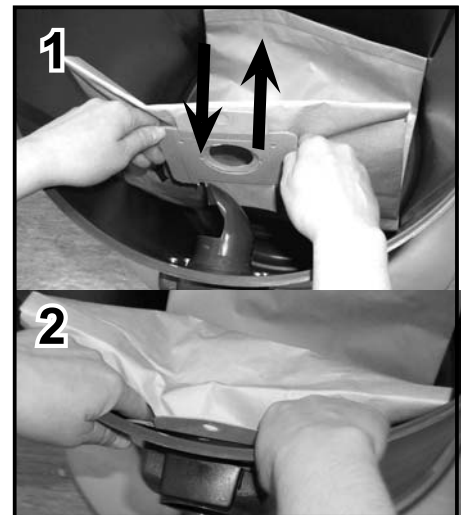

Wet use



Fit the float valve

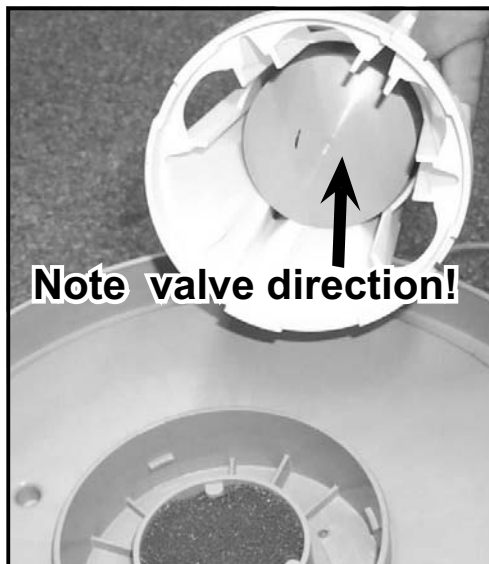

Fit the float basket

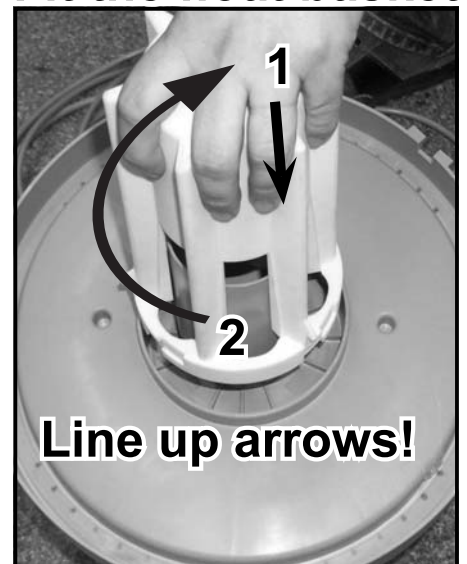

Switch on/off



Wind up CORD

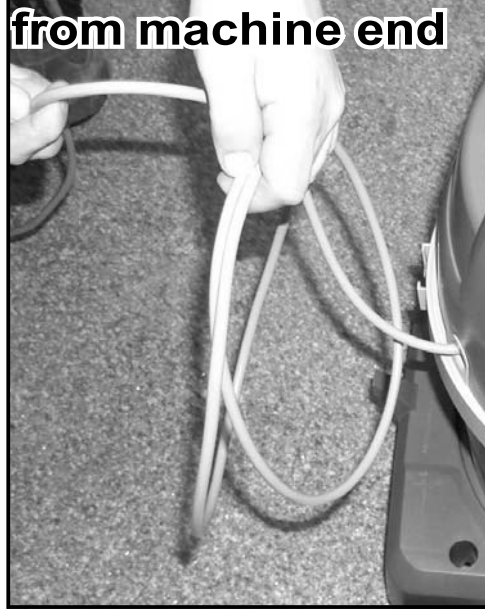

from machine end

Cartridge filter

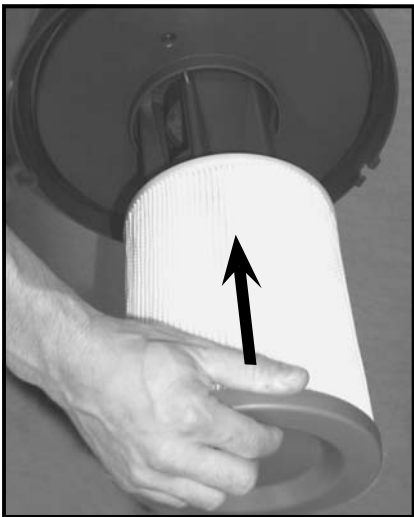

Filter basket

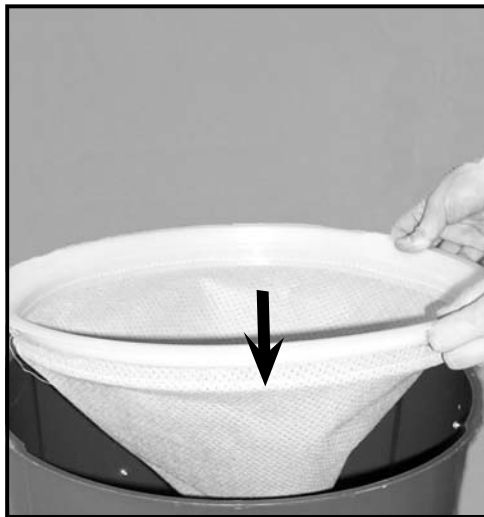

Filter basket



To remove float

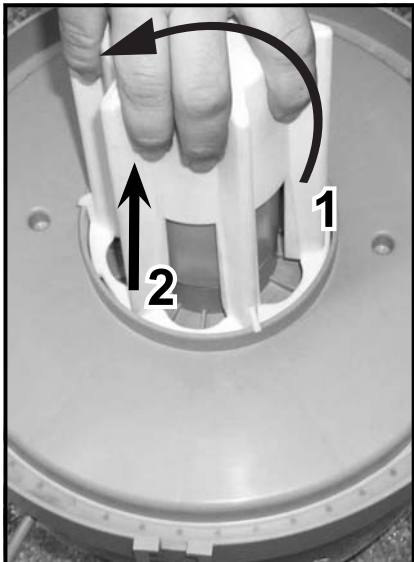

**Emptying after
Wet cleaning -**

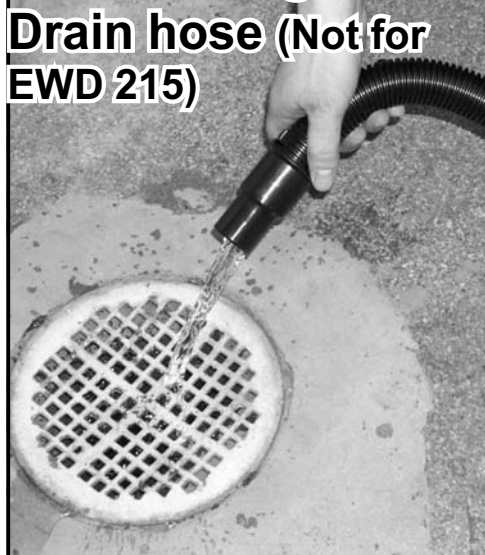

**EWD 215 - emptying
after wet cleaning -**



SAFETY INSTRUCTIONS

**THIS VACUUM CLEANER IS DESIGNED FOR COMMERCIAL USE.
ACCIDENTS DUE TO MISUSE CAN ONLY BE PREVENTED BY THOSE USING THE MACHINE.
READ AND FOLLOW ALL SAFETY INSTRUCTIONS.**



WARNING!

To reduce the risk of fire, electric shock, or injury, please read and follow all safety instructions and caution markings before use. This vacuum cleaner is designed to be safe when used for cleaning functions as specified. Should damage occur to electrical or mechanical parts, the cleaner and / or accessory should be repaired by a competent service station or the manufacturer before use in order to avoid further damage to the machine or physical injury to the user.

- Do not use outdoors.
- Do not leave the machine when it is plugged in. Unplug from the socket when not in use and before maintenance
- Do not use with damaged cord or plug. To unplug grasp the plug, not the cord. Do not handle plug or cleaner with wet hands. Turn off all controls before unplugging.
- Do not pull or carry by cord, use cord as a handle, close a door on cord, or pull cord around sharp edges or corners. Do not run cleaner over cord. Keep cord away from heated surfaces.
- Keep hair, loose clothing, fingers and all parts of the body away from openings and moving parts. Do not put any objects into openings or use with opening blocked. Keep openings free of dust, lint, hair, and anything else that could reduce the flow of air.
- Do not use to pick up flammable or combustible liquids such as gasoline, or use in areas where they may be present.
- Do not pick up anything that is burning or smoking, such as cigarettes, matches or hot ashes.
- The appliance is not intended for use by young children or infirm persons. Young children should be supervised to ensure that they do not play with the appliance.
- Use extra care when cleaning on stairs.
- Do not use unless filters are fitted.
- If the cleaner is not working properly or has been dropped, damaged, left outdoors, or dropped into water, return it to a service center or dealer.
- Use only as described in this manual and only with the manufacturer's recommended attachments.

GENERAL INFORMATION

BEFORE YOU PLUG IN YOUR CLEANER, check the rating plate located on the cleaners back side to see if the rated voltage agrees within 10% of the voltage available.

DO NOT OIL, the motor in your new cleaner is permanently lubricated and sealed. Do not oil the motor at any time.

During shipping, the dust bag may have become dislodged. Check the bag to insure proper seating before attempting to use the cleaner. Do not operate the cleaner without the filters installed as damage may result to the motor.

The machine is equipped with a thermal breaker to protect the motor and other vital machine parts from overheating. Should this breaker open, you will have to wait at least 5-10 minutes before you try to start it again. While you are waiting, switch the machine off and unplug it, then check the hose, dust bag and filters to be sure that nothing is blocking the flow of air through the machine.

Note! It is necessary to reset the machine by pressing the on/off button, the machine will not start again until this is done.

For longer service life and safe use of your vacuum cleaner, we recommend the following guidelines: Your cleaner is designed to pick up dirt and dust particles and water. Avoid picking up hard or sharp objects with your cleaner to avoid bag breakage, clogging or possible motor damage.

SERVICE INFORMATION

To obtain consistent performance over the life of your vacuum, read through these instructions and keep them handy for future reference. If you require service, contact the dealer from whom the vacuum was purchased, or the local authorized Service Station. Always refer to your Service Station for complete service information. For prompt and complete service information, always refer to the model, type and serial number indicated on the rating plate.

IMPORTANT!

The machine is equipped with a specially designed cord which if damaged, must be replaced by a cord of the same type. This is available at authorised service centres and dealers and must be installed by trained personnel.

NOTE!

Remove the plug from the socket before performing maintenance. Before using the machine make sure that the frequency and voltage shown on the rating plate correspond with the mains voltage.

Specifications and details are subject to change without prior notice. The accessories shown in the pictures may vary from model to model.

SAVE THESE INSTRUCTIONS

GROUNDING / DOUBLE INSULATION INSTRUCTIONS

GROUNDING INSTRUCTIONS (USA, Canada)

Applicable to machines with a three-pin plug

This appliance must be grounded. If it should malfunction or breakdown, grounding provides a path of least resistance for electric current to reduce the risk of electric shock. This appliance is equipped with a cord having an equipment-grounding conductor and grounding plug. The plug must be plugged into an appropriate outlet that is properly installed and grounded in accordance with all local codes and ordinances.



DANGER!

Improper connection of an equipment-grounding conductor can result in risk of electric shock. Check with qualified electrician or service person if you are in doubt as to whether the outlet is properly grounded. Do not modify the plug provided with the appliance. If it will not fit the outlet, have proper outlet installed by a qualified technician.

This appliance is for use on a nominal 120 volt circuit and has a grounding plug that looks like the plug illustrated in Figure A. A temporary adaptor which looks like the adaptor illustrated in Figure B may be used to connect this plug to a two-pole receptacle, as shown, if a properly grounded outlet is not available. The temporary adaptor should be used only until a properly grounded outlet, Figure A, can be installed by a qualified electrician. The green colored rigid ear, lug, or the like extending from the adaptor must be connected to a permanent ground such as a properly grounded outlet box cover. Whenever the adaptor is used, it must be held in place by a metal screw.

NOTE! This temporary adaptor is not permitted in Canada

SERVICING OF DOUBLE-INSULATED APPLIANCES

Applicable to machines with a two-pin plug

In a double-insulated appliance, two systems of insulation are provided instead of grounding. No grounding means is provided on a double-insulated appliance, nor should a means for grounding be added to the appliance. Servicing a double-insulated appliance requires extreme care and knowledge of the system, and should be done only by qualified service personnel. Replacement parts for a double-insulated appliance must be identical to the parts they replace. A double insulated appliance is marked with the words

"DOUBLE INSULATION" or
"DOUBLE INSULATED."

The symbol (square within a square) may also be used on the product.



SERVICE INFORMATION

To obtain consistent performance over the life of your vacuum, read through these instructions and keep them handy for future reference. If you require service, contact the dealer from whom the vacuum was purchased, or the local authorized Service Station. Always refer to your Service Station for complete service information. For prompt and complete service information, always refer to the model, type and serial number indicated on the rating plate.

IMPORTANT

If the supply cord of this appliance is damaged, it must be replaced by a repair shop appointed by the manufacturer as special purpose tools are required.

FIGURE A

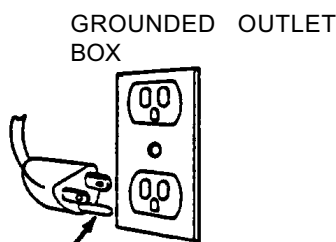

GROUNDING BLADE IS LONGEST OF THE THREE BLADES

FIGURE B

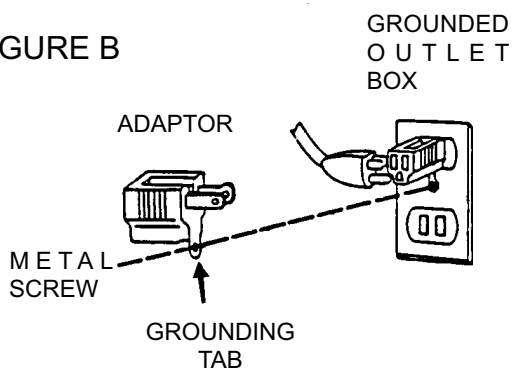

Dry Use

This machine has a number of dry material pick up options that should be considered. This machine shall always have the filter basket and the float basket mounted when picking up dry material. This is also valid when using a dust bag.

Filter Basket:

A filter basket comes standard with this machine. It can be used to collect a large amount of dry material directly in the tank. It also can function as a pre-filter to extend the life of the cartridge filter or HEPA filter.

Dust Bag:

Dry material can be collected in a dust bag and then easily disposed of without creating a mess.

Cartridge Filter:

The optional cartridge filter provides even finer particle filtration than the dust bag or filter basket.

HEPA Protection Ring (HPR) and HEPA Filter:

The optional HPR and HEPA filter provide true HEPA filtration according to DOP MIL-STD-282 specifications. The HPR must always be used when the HEPA filter is used for either wet or dry pick up.

How to Use the Filter Basket:

The filter basket should always be used when collecting dry material. It should never be used when collecting wet or moist material. The filter basket always is mounted directly on top of the tank. The float shut off valve or cartridge filter must be installed when the filter basket is used. The filter basket can be used alone to collect a large volume of dry material directly into the tank. The filter basket also serves as a pre-filter when using the optional cartridge filter or HEPA Protection Ring (HPR) and HEPA filter and serves to extend the life of these filters. The filter basket should be installed between the tank and the motor top or between the tank and HPR. The filter basket is washable. Wash using mild detergent. Dry thoroughly before use. It can also be vacuumed off with another HEPA filtered vacuum.

How to Use the Dust Bag:

The dust bag provides a neat and clean way to dispose of dry material. It is not reusable or washable. Secure the dust bag to the inlet on the inside of the tank by sliding the cardboard piece with rubber membrane over the inlet. Make sure the bag is pushed on as far as it will go. During use, check the bag frequently and remove and dispose of when about 2/3 full. Overfilling the bag may make it more difficult to remove and increases the risk of the bag breaking and spilling the contents.

How to Use the Cartridge Filter:

The cartridge filter is for dry use only and provides better filtration than the dust bag and/or the filter basket. The use of the filter basket and/or dust bag helps ensure longer life of the cartridge filter by acting as a pre-filter for larger debris. The cartridge filter can be mounted directly to the motor top or to the bottom of the HPR. The cartridge filter mounts in place of the float shut basket. Remove the float shut off valve by rotating it counter clockwise and then install the cartridge filter by pushing it in place.

Be careful to not damage the filter media. The cartridge filter is not washable. It may be cleaned by gently vacuuming it with a HEPA vacuum and a soft brush. Be careful not to puncture or damage the filter media. Do not use compressed air to clean the filter.

How to Use the HEPA Protection Ring (HPR) and HEPA Filter:

The HPR and HEPA filter work together to provide true HEPA filtration capturing 99.97% of particles that are 0.3 microns and larger. The HPR must always be used when the HEPA filter is used. For dry applications the use of the filter basket in conjunction with the dust bag or cartridge filter is highly recommended to extend the life of the HEPA filter. When vacuuming dry hazardous material it is recommended to use a dust bag, filter basket, cartridge filter and HEPA filter. For wet or moist applications the float shut off valve should be installed and no other filters should be used except the HEPA filter. The HEPA filter is not washable and no maintenance should be performed on the filter itself. Once the filter becomes clogged it should be disposed of in accordance with federal, state and local laws and regulations.

Wet Use

The vacuum is equipped with a float shut off valve that shuts off the vacuum when the maximum fluid level has been reached. The purpose is to protect the vacuum motor by shutting off the air flow before motor damage occurs. When the maximum level is reached there will be a significant change in sound and airflow through the hose will decrease.

The float shut off valve is removable and can be placed either on the motor top itself or on the bottom of the HEPA Protection Ring. The float shut off should be cleaned after each use with a damp cloth and mild detergent.

When re-installing the float shut off valve, make sure the float itself is installed correctly. The open end should be pointing down into the tank and the closed end should face upwards towards the motor top. Installing the float in the wrong orientation will allow water to collect inside the float. In this case it will not float and will not shut off the vacuum properly. Water will then be drawn into the motor top and will destroy the vacuum.

For wet applications, no other filters should be used except the HEPA filter.

Draining

These machines is equipped with a rear mounted drain hose (Not model EWD 215) that makes empty the contents quick, easy and clean. Simply remove the end cap from the hose and slowly lower the drain hose to release the contents.

Draining of model 215

Remove the motor top and tilt the container backwards and pour the contents into a floor drain.

USE AND SERVICE INSTRUCTIONS WHEN USED IN HAZARDOUS SUBSTANCE RECOVERY



WARNING

To reduce the risk of exposure to hazardous substances you must read and follow all safety instructions in this Instructions for Use manual.

Attention Employer

- Please ensure the Instructions for Use manual are provided to and understood by your employees or any other persons who use this equipment.
- To list all toxic and hazardous substances would be beyond the scope of these instructions. It is the employer's and operator's responsibility to identify hazardous or toxic substances which may be collected by the equipment during operation. Such information must be communicated to operators and other potential users of this equipment.
- This cleaner is designed for recovery and collection of dust, debris and particulate matter only.
- This cleaner is not suitable for recovery and collection of any form of hazardous vapors. Do not use the cleaner if these vapors are present.
- This cleaner is not suitable for recovery and collection of flammable or explosive solvents, chemicals, or liquids. Do not use the cleaner if these liquids are present.

General Instructions

- Contact with the cleaner, dustbag, filter and all other accessories used when picking-up hazardous materials must be handled according to federal (EPA, OSHA), state and local regulations valid for the vacuumed substance.
- Do not use this cleaner for the removal of hazardous substances unless you are licensed and/or certified for this work by the all authorities having jurisdiction.

Instructions for Use

- Operation of the cleaner when picking up hazardous substances must be accompanied by the use of appropriate personal protective clothing and respiratory protection.
- Do not pick-up hazardous substances without the HEPA filter in place.
- If this vacuum cleaner is used to collect hazardous substances, do not attempt to open or empty its contents without the use of personal protective clothing and respiratory protection.
- If the cleaner is not working properly or has been dropped, damaged, left out doors, or dropped into water, return it to a qualified service center or dealer.
- This cleaner circulates ambient air for cooling the vacuum motor. Hazardous particles may accumulate in the internal motor cooling air ducts and could be released into the exhaust airstream at any time. If the cleaner is used in an enclosed contaminated environment, it should be committed exclusively to this type of environment and not operated outside of an enclosed and controlled environment.
- Before the cleaner and any accessories are removed from a controlled environment, all external surfaces must be decontaminated according to federal (EPA, OSHA), state and local regulations valid for the vacuumed substance.

Filter Replacement

- All disposed filters, bags, and debris should be treated as a hazardous substance and must be disposed in accordance with all federal, state, and local regulations.
- Use only approved Euroclean vacuum filters and bags.
- The following is a recommended replacement interval for all of the filters and bag. These items should be replaced more often if you experience a loss of performance.
- Disposable filter dust bags – When the bag is 2/3 full it should be replaced. Excessive over filling of this bag makes it difficult to remove from the vacuum tank and can result in breakage and spills.
- Motor pre-filter – This filter should be replaced or vacuumed thoroughly using a HEPA vacuum with every fifth change of bag or whenever there is a visible collection of debris on the filter.
Filter basket – This filter should be replaced or vacuumed thoroughly using a HEPA vacuum with every change of bag or whenever there is a visible collection of debris on the filter.
- Cartridge filter – This filter should be replaced with every fifth change of the pre-filter or whenever there is a visible collection of debris on the filter.
- HEPA filter – Replace this filter at least every six months or more often if a loss of vacuum continues after you have replaced all other filters and the bag.

How to examine filters

- Filters collect and are contaminated with hazardous substances. The inspection and or replacement of any filter must only be done with the use of personal protective clothing, proper respiratory protection and in a controlled environment.
- The filter basket and the HEPA filter cannot be cleaned. Periodically make a visual inspection of each filter for a build-up of debris or damage to the sealing surfaces. If any filter appears to be clogged, damaged in any way, or has changed color (HEPA-filter should be white) which indicates excessive dirt build-up, replace with a new filter making sure to install new secondary and primary filters.
- If any visible dust particle emissions are observed in the vacuum exhaust air stream, stop operations immediately. If this occurs, the HEPA filter has ruptured or failed and must be replaced.

Service Instructions

- If this cleaner has been used to pick-up hazardous substances in an enclosed contaminated environment, the internal components of the powerhead may be contaminated.
- External decontamination of the cleaner must be carried out. However, external decontamination will not eliminate any internal contamination. Any servicing of the powerhead involving disassembly must be done inside of a contained environment by trained service personnel using appropriate personal protective clothing and respiratory protection.
- Any replaced components or debris collected during servicing should be treated as a hazardous substance and must be disposed of in accordance with all federal, state, and local regulations.
- All sealing rings and gaskets should be replaced anytime the unit is disassembled to assure high machine efficiency.

| ENGLISH SPECIFICATIONS | | EWD 315 120V | EWD 320 120V | EWD 215 120V | EWD 260 120V |
|--------------------------------|--------|-----------------|-----------------|-----------------|-----------------|
| Rated power | W | 1350 | 1350 | 1350 | 1350 |
| Protection grade (moist, dust) | - | IP24 | IP24 | IP24 | IP24 |
| Protection class (electrical) | - | II □ | II □ | II □ | II □ |
| Airflow with hose and tube | l/sec | 42 | 42 | 42 | 42 |
| Vacuum, at nozzle | kPa | 22 | 22 | 22 | 22 |
| Suction power with hose | W | 260 | 260 | 260 | 260 |
| Sound power IEC 704 2.1 | dB(A) | 81 | 81 | 81 | 81 |
| Sound preassure BS 5415 | dB(A) | 64 | 64 | 64 | 64 |
| Dust bag capacity | Gallon | 3.43 | 4.49 | 3.43 | 4.49 |
| Tank capacity | Gallon | 15 gross | 20 gross | 5 gross | 20 gross |
| Weight, cleaner only | Oz | 529 | 705 | 282 | 710 |

Specifications and details are subject to change without prior notice.

| FRANÇAIS CARACTÉRISTIQUES TECHNIQUES | | EWD 315 120V | EWD 320 120V | EWD 215 120V | EWD 260 120V |
|---|--------|-----------------|-----------------|-----------------|-----------------|
| Puissance nominale | W | 1350 | 1350 | 1350 | 1350 |
| Classe de protection (humidité, poussière) | - | IP24 | IP24 | IP24 | IP24 |
| Classe de protection (électricité) | - | II □ | II □ | II □ | II □ |
| Débit avec tuyau et tubes | l/sec | 42 | 42 | 42 | 42 |
| Aspiration à l'embout | kPa | 22 | 22 | 22 | 22 |
| Puissance d'aspiration avec tuyau | W | 260 | 260 | 260 | 260 |
| Puissance sonore IEC 704 2.1 | dB(A) | 81 | 81 | 81 | 81 |
| Pression sonore BS 5415 | dB(A) | 64 | 64 | 64 | 64 |
| Capacité sac à poussière | Gallon | 3.43 | 4.49 | 3.43 | 4.49 |
| Capacité réservoir | Gallon | 15 gross | 20 gross | 5 gross | 20 gross |
| Poids, aspirateur seul | Oz | 529 | 705 | 282 | 710 |

Les caractéristiques des matériaux peuvent être modifiées à tout moment, en fonction de l'évolution technique.

| ESPAÑOL ESPECIFICACIONES | | EWD 315 120V | EWD 320 120V | EWD 215 120V | EWD 260 120V |
|--------------------------------------|--------|-----------------|-----------------|-----------------|-----------------|
| Potencia nominal | W | 1350 | 1350 | 1350 | 1350 |
| Grado de protección (humedad, polvo) | - | IP24 | IP24 | IP24 | IP24 |
| Clase de protección (eléctrica) | - | II □ | II □ | II □ | II □ |
| Flujo de aire con manguera y tubo | l/seg | 42 | 42 | 42 | 42 |
| Aspiración, en la boquilla | kPa | 22 | 22 | 22 | 22 |
| Potencia de succión con manguera | W | 260 | 260 | 260 | 260 |
| Potencia acústica IEC 704 2.1 | dB(A) | 81 | 81 | 81 | 81 |
| Presión del sonido BS 5415 | dB(A) | 64 | 64 | 64 | 64 |
| Capacidad de la bolsa del polvo | Gallon | 3.43 | 4.49 | 3.43 | 4.49 |
| Capacidad del depósito | Gallon | 15 gross | 20 gross | 5 gross | 20 gross |
| Peso, aspiradora solamente | Oz | 529 | 705 | 282 | 710 |

Las especificaciones y detalles pueden sufrir variaciones sin previo aviso.